

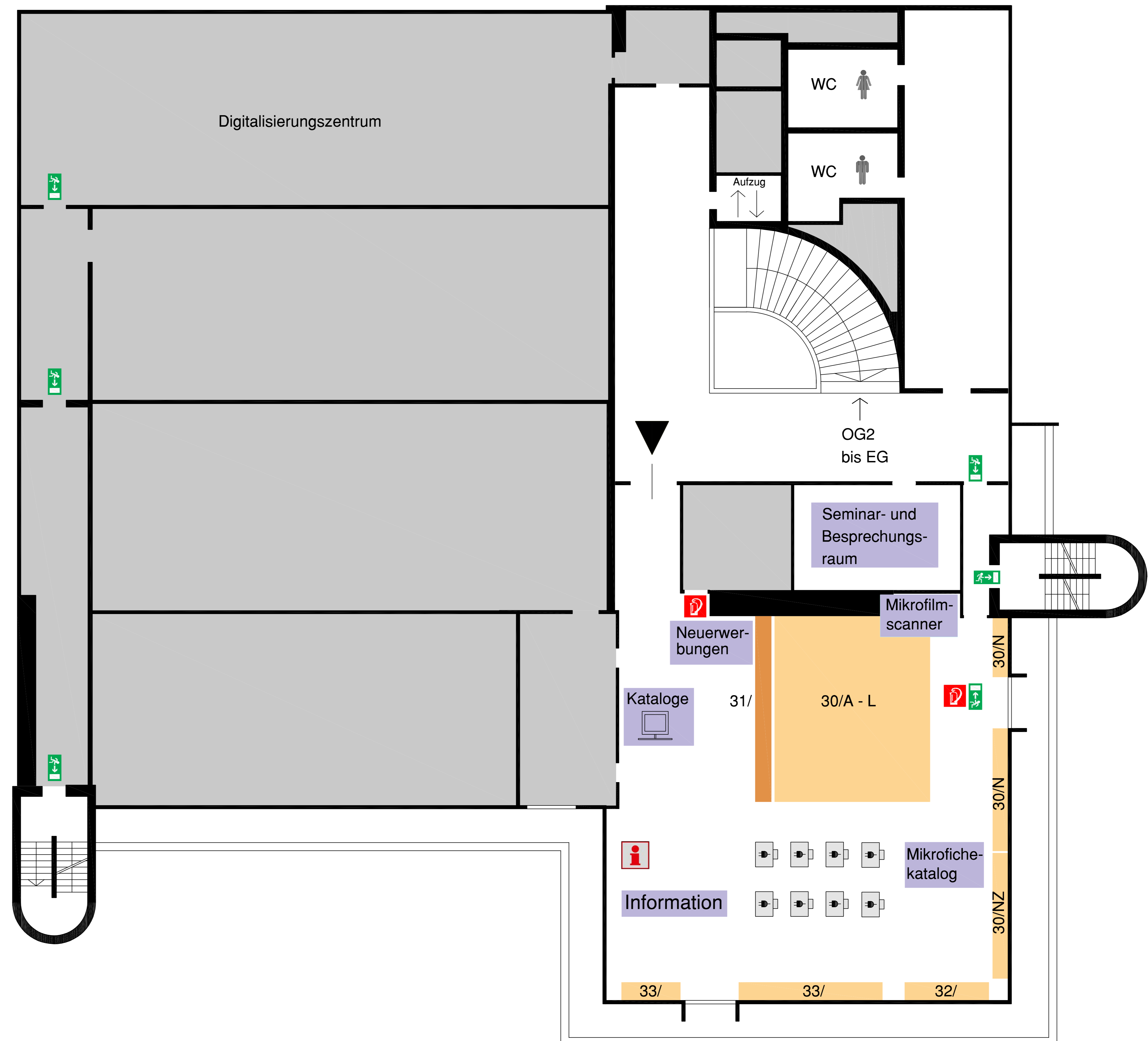







# 3. Obergeschoss Lesesaal Sondersammlungen

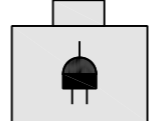

## Handschriften und Alte Drucke Fränkische Landeskunde

- |   |                         |   |                              |
|---|-------------------------|---|------------------------------|
|  | 30/ bis 33/ Monografien |  | Arbeitsplätze mit Steckdosen |
|  | 31/ Zeitschriften       |  | Computerarbeitsplätze        |
|  | Servicebereiche         |  | Feuerlöscher                 |
|  | Verwaltungsbereich      |  | Notausgang                   |

